

REVISIONS				
ZONE	REV	DESCRIPTION	DATE	APPROVED
	A	INITIAL RELEASE	03/12/2024	D.B

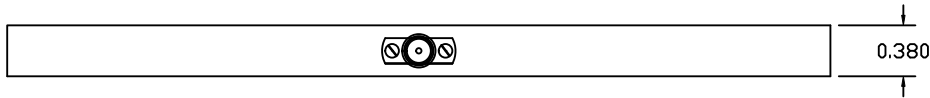

THRU MOUNTING HOLES 4 PLACES

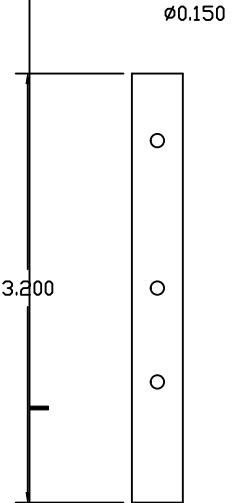

∅0.150

FIELD REMOVABLE SMA ( F )



J0

6X 4-40 UNC-2B 200DP FOR SIDE MOUNTING

**S2D Microwave Inc**

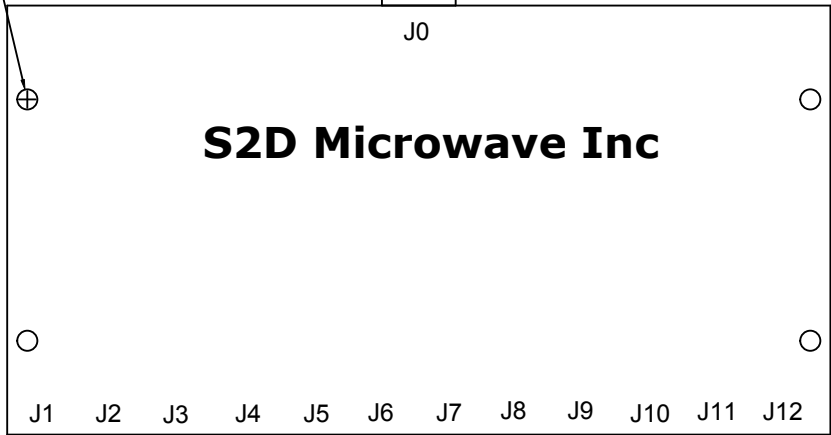

**SPECIFICATIONS**

Type :.....SP12 Way Power Splitter  
 Frequency :.....7 - 13 GHz  
 Operating Input Power :.....+33dBm max  
 Phase and Amplitude match.....+/-0.8deg, +/-0.5dB  
 Insertion Loss :.....-3.0dB max  
 Port Isolation :.....18dB min  
 VSWR :.....1.8: 1  
 Impedance :.....50 Ohms

RF Connector :.....SMP SB - Female

**ENVIRONMENTAL RATINGS**

Temperature : .....- 40°C to + 80°C (Operating)  
 - 65°C to +125°C (Storage)

Moisture & Resistance :.. Mil STD-202 Method 106  
 Shock :..... Mil STD-202 Method 213, Con C  
 Vibration :..... Mil STD-202 Method 201  
 Humidity..... Mil STD-202F, Method 103B Con.B

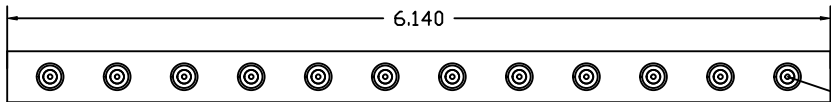

SMP SB X12

OUTLINE DRAWING  
 S96\_1x12\_PD\_713GHZ\_SMP\_LD  
 HOUSING # S96-0324-01

NOTE: Specifications are subject to revision or change  
 Units are designed to meet the environmental rating.  
 For environmental testing please contact sales@s2dmicrowave.com.

All Dimensions in Inches	
Tolerances:	
Fractions	Decimals Angles
-	±0.01 ±3°
	±0.005
Model# S96-12PD0713SMP	
Material: AL Alloy 6061-T6 per QQ-A-250/11	
Plating:	



OUTLINE DRAWING  
 SP12 WAY POWER SPLITTER

SIZE	FSCM NO. 65BW0	DWG NO. 100-0324-S96-01	REV
SCALE: None		SHEET 1 of 1	